

Accessories

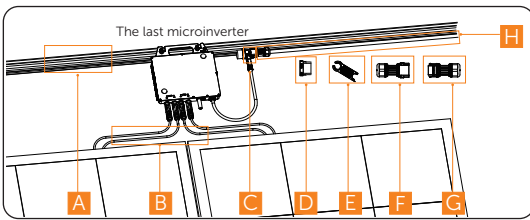

No.	Description
A	1.2m/2m/2.4m AC trunk cable
B	DC extension cable (if necessary)
C	AC trunk connector
D	AC trunk end cap
E	AC trunk port disconnect tool
F	Female connector
G	Male connector
H	AC end cable-M

*Note: The above accessories are not included in the package and need to be purchased separately.

Installation Steps

Rail installation

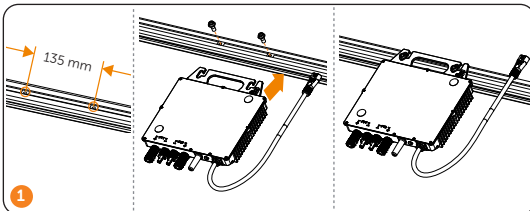

*Note:

- Choose the screwdriver according to the corresponding screws of the rail.
- Please use 4-6 mm² three core soft wire cable. Single core hard wire cable cannot be used in the following steps.

Balcony installation

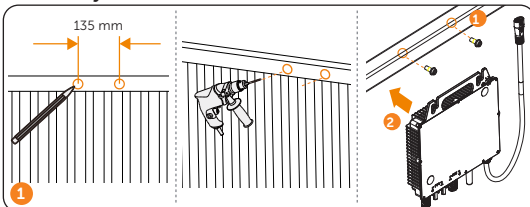

*Note: The following installation steps are equally applicable for rail installation and balcony installation.

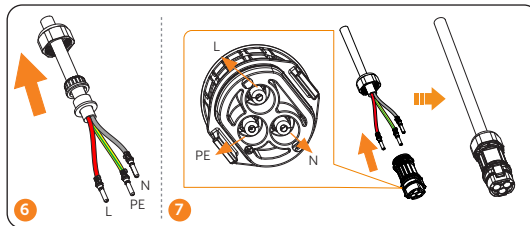
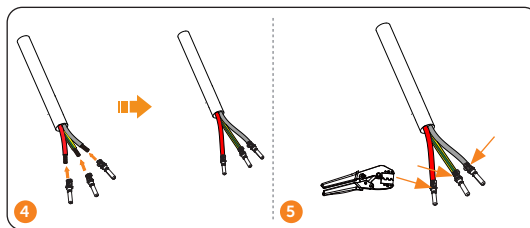
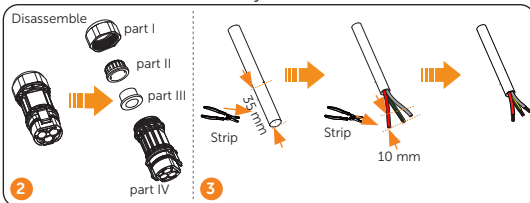

*Note:

- The connection between female connector and AC trunk cable is the similar to that of male connector. Connect female connector with female pin contact and install the female connector at the other side of AC trunk cable.
- Choose the cable tie according to the rail width and the length of self-purchased accessories.
- Avoid placing AC connectors nearby any drainage channels.
- AC trunk connectors should be placed nearby the AC cable of microinverters.
- Select the AC cable with an appropriate length according to the actual installation situation.

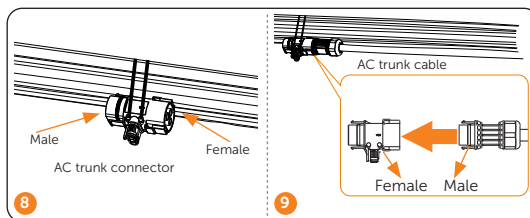

*Note: In order to better fix the AC trunk cable, it is recommended to use more cable ties to band the AC trunk cable.

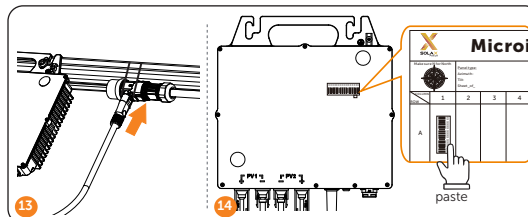
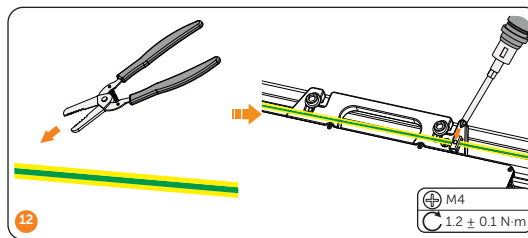
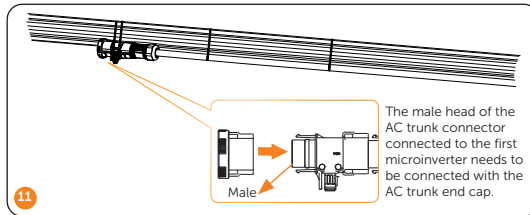
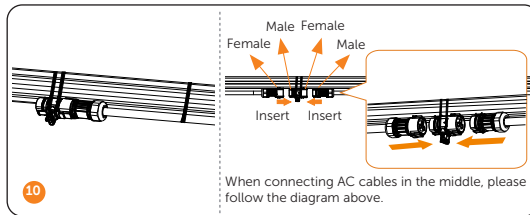

*Note:

- The AC cable includes an earth wire, allowing for direct grounding.
- For regions with specific requirements, optional grounding brackets are available to complete the external grounding. Choose the suitable grounding method according to local safety regulations.

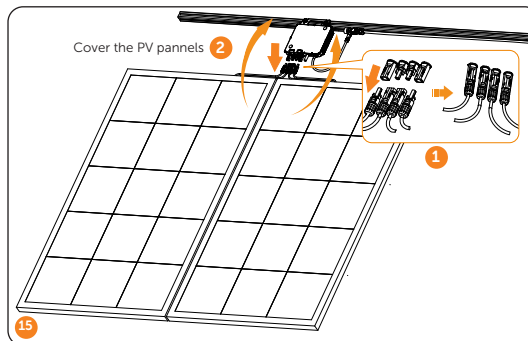

*Note:

- At least two or three trained and experienced workers are required to finish this step.
- Please connect PV terminals in the correct way. Reverse connection may damage the microinverter!
- If the panels are too far from the microinverter, please use DC extension cable for connection.
- The length of AC end cable shall depends on the actual installation scene.

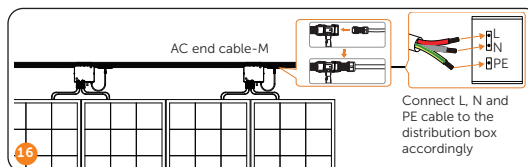

*Note:

- Please use 4-6 mm² three core soft wire cable. Single core hard wire cable cannot be used in the following steps.
- If you didn't buy AC end cable-M, please follow step 2-7 to make the wire before connecting to the distribution box.

Power on the System

Step 1: First turn on the AC breaker on the branch circuit and then the main AC breaker of the house.

Step 2: Wait for about 2 minutes until the system is initiated.

Wi-Fi Configuration



Download APP



WiFi Configuration Guide

LED Indicator Status

LED Indicator Status	Description
Yellow light flash	If the light flashes once in 1s, or flashes in 10s, microinverter is starting up; If the light still flashes after 10s, microinverter startup fails or DSP firmware is upgrading.
Yellow light steady on	Microinverter standby/self-checking.
Green light flash (5s)	Normal operation; normal AC grid; communicating with router.
Green light flash (2s)	Normal operation; normal AC grid; no connection with router.
Red light flash (2s)	No AC grid or AC grid outside the regulatory range.
Red light steady on	Error: non-grid abnormal fault. Machine fault like grounding detection fault and PV side fault.

About 10s after connection with DC power, the light turns yellow;
The yellow light flashes for 10s continuously and then keeps steady on which stands for microinverter self-check;
Afterwards, if the system is not powered on, the red light will flash, indicating for no grid existence;
After microinverter connects with DC power for the first time, red light flashes indicates for errors during microinverter startup.

Warranty Registration

Please visit the website: <https://www.solaxcloud.com/user-center/> to complete the warranty registration. For more detailed warranty terms, please visit SolaX official website: www.solaxpower.com.

User Manual

Please visit the website: <https://www.solaxpower.com/products/x1-microinverter-2-in-1-g2.html> for the more instructions of the microinverter.

SolaX Power Network Technology (Zhejiang) Co., Ltd.

ADD.: No. 278, Shizhu Road, Chengnan Sub-district, Tonglu County, Hangzhou, Zhejiang, China
E-mail: info@solaxpower.com

Copyright © SolaX Power Network Technology (Zhejiang) Co., Ltd.
All rights reserved.

320102156900

